

HabaCHAIN®

Installation instructions for chain types C1700 and C1701:

Please find more information in the Engineering Guide 6017 on www.habasit.com

Note: Habasit C1700 and C1701T will interlace with the Competitors. Habasit pin is “D” shape and competitor’s is round. Use the pin for the chain manufacture at the yoke portion.

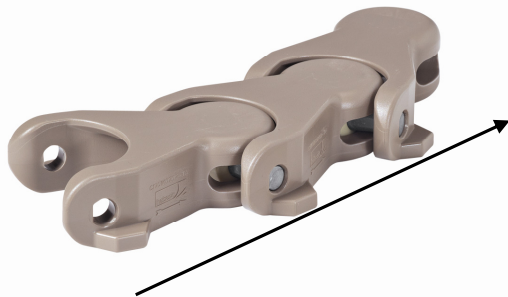

Direction of travel

These chains are Uni-directional. Barrel of chain always leading.

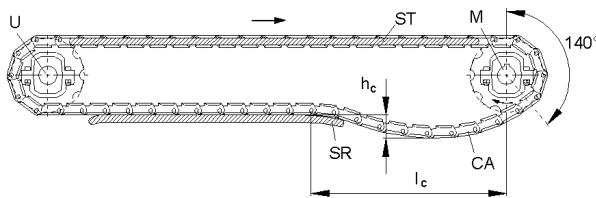

Catenary Sag and sprocket wrap

Unsupported chain length to allow variable length due to temperature and exerts a tension on the chain for proper sprocket engagement.

Sag: $H = 25 \text{ mm} - 100 \text{ mm}$ (1" – 4")

Length: $L = 460 \text{ mm} - 610 \text{ mm}$ (18" – 24")

Sprocket wrap: 140°

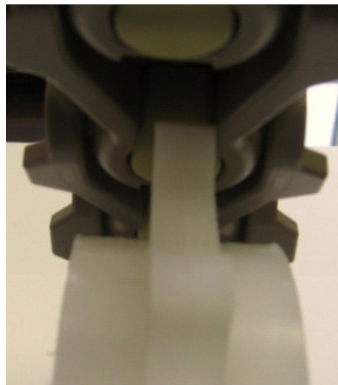

Chain entering sprocket

Center sprocket in the center and drive against the pivot of the chain.

Pin installation



Pull chain together lacing the hinges.

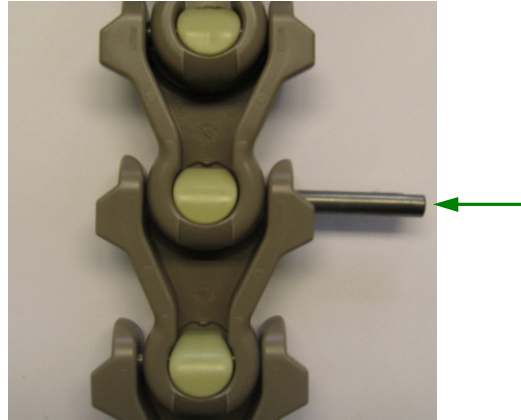

Insert the pivot with rounded edge to open end of chain link. Insert pin from most accessible side, pin can be installed from either side.

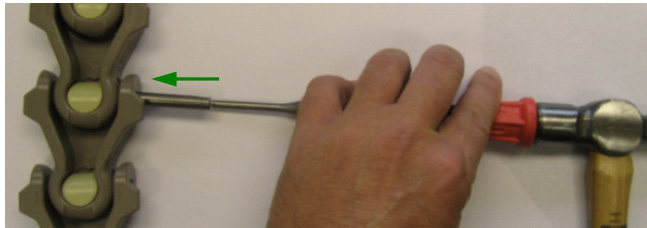

Hammer in Pin to be seated flush to slightly below flush. Helpful hint: Connect and disconnect chain over sprocket will help hold chain while hammering

Pin Removal



Hammer pin out from most accessible side. Hold back link edge opposite of the hammer.

The chain must not be in tension.

Product liability, application considerations

If the proper selection and application of Habasit products are not recommended by an authorized Habasit sales specialist, the selection and application of Habasit products, including the related area of product safety, are the responsibility of the customer.

All indications / information are recommendations and believed to be reliable, but no representations, guarantees, or warranties of any kind are made as to their accuracy or suitability for particular applications. The data provided herein are based on laboratory work with small-scale test equipment, running at standard conditions, and do not necessarily match product performance in industrial use. New knowledge and experiences can lead to modifications and changes within a short time without prior notice.

BECAUSE CONDITIONS OF USE ARE OUTSIDE OF HABASIT'S AND ITS AFFILIATED COMPANIES CONTROL, WE CANNOT ASSUME ANY LIABILITY CONCERNING THE SUITABILITY AND PROCESS ABILITY OF THE PRODUCTS MENTIONED HEREIN. THIS ALSO APPLIES TO PROCESS RESULTS / OUTPUT / MANUFACTURING GOODS AS WELL AS TO POSSIBLE DEFECTS, DAMAGES, CONSEQUENTIAL DAMAGES, AND FURTHER-REACHING CONSEQUENCES.



Version Nov. 2012